

## SK25 Collets

### SK25 Collets

Size range: 16.0mm - 25.4mm (0.630 - 1.000")

#### Metric

Part Number	Collapse Range (mm)	Collapse Range (in)
SK25-16.5	16.0 - 16.5	0.630 - 0.649"
SK25-17	16.5 - 17.0	0.649 - 0.669"
SK25-17.5	17.0 - 17.5	0.669 - 0.688"
SK25-18	17.5 - 18.0	0.688 - 0.708"
SK25-18.5	18.0 - 18.5	0.708 - 0.728"
SK25-19	18.5 - 19.0	0.728 - 0.748"
SK25-19.5	19.0 - 19.5	0.748 - 0.767"
SK25-20	19.5 - 20.0	0.767 - 0.787"
SK25-20.5	20.0 - 20.5	0.787 - 0.807"
SK25-21	20.5 - 21.0	0.807 - 0.826"
SK25-21.5	21.0 - 21.5	0.826 - 0.846"
SK25-22	21.5 - 22.0	0.846 - 0.866"
SK25-22.5	22.0 - 22.5	0.866 - 0.885"
SK25-23	22.5 - 23.0	0.885 - 0.905"
SK25-23.5	23.0 - 23.5	0.905 - 0.925"
SK25-24	23.5 - 24.0	0.925 - 0.944"
SK25-24.5	24.0 - 24.5	0.944 - 0.964"
SK25-25	24.5 - 25.0	0.964 - 0.984"
SK25-25.4	25.0 - 25.4	0.984 - 1.000"
SK25-SET-19-MM	19 Piece SK25 Collet Set - 16.0mm - 25.4mm	

#### Inch

Part Number	Size
SK25-3/16A	0.187"
SK25-1/4A	0.250"
SK25-5/16A	0.312"
SK25-3/8A	0.375"
SK25-7/16A	0.437"
SK25-1/2A	0.500"
SK25-5/8A	0.625"
SK25-3/4A	0.750"
SK25-SET-08-A	8 Piece SK25 Collet Set - 3/16 - 3/4" X16th

These inch size collets do not collapse.

#### Dimensional Data

Collet Series	C1	L1	Collapse Range (D1)
SK25	1.378" (35mm)	2.244" (57mm)	0.630 - 1.000" (16.0 - 25.4mm)

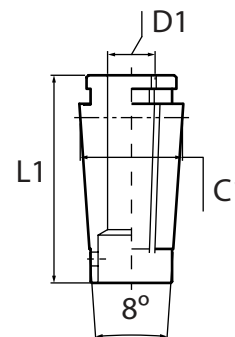

### Metric - Coolant-Thru

Up to 1000 psi capable.

Part Number	Size	Note:
SK25-20AC	20mm	Cutter must be inserted to the full length of the collet.
SK25-25AC	25mm	

### Inch - Coolant-Thru

Up to 1000 psi capable.

Part Number	Size	Note:
SK25-3/4AC	0.750"	AC-type collets are mechanically sealing and can handle coolant through the tool up to 1000 psi. No additional coolant disk or nut is required when using these collets.
SK25-7/8AC	0.875"	

### SK25 Collet Rack



Part Number	Description
RACK-5C/100TG/SK25	SK25 collet rack, 30 pieces capacity

Note: SK Collet Drill Chart available on page 248 in the Technical section.

